

ISUZU 7TH GENERATION

F-SERIES



Experience MORE

Experience More with ISUZU F SERIES TRUCKS

Local distributors, construction companies and businesses around the world count on Isuzu F Series Trucks, to deliver MORE value cost effectively, so you have a solid competitive edge in today's dynamic business environment. The Isuzu F Series line up incorporates an innovative design, versatility and dependable performance that are vital to success and meets the demands of the operators.

The comprehensive range of advanced F-Series trucks provides operators with the right options to meet the most demanding requirements from freight carriers and compactors to medium and heavy haul operations and off-road application.





Anytime tough: Rugged and Reliable for the Jobs You Do



Proven Power, Performance and Payload

OPTIMIZED FOR CARRYING CAPACITY AND RELIABILITY

Every businessman wants to optimize payload per trip. What better way to do this with a rigid chassis and optimal wheelbase dimensions in the 7th Generation F series trucks. As they cover the distance, they are engineered to handle heavy loads and a broad variety of rear bodies.

Placing the front axle slightly to the rear not only maximizes carrying capacity, it also reduces overall length and allows for larger cab steps throughout the journey.



A detailed view of the interior of an Isuzu F-Series truck cab. The image shows the driver's side with a large, perforated leather seat, a steering wheel, a dashboard, and a gear shift. The cab is spacious, with a high ceiling and large windows. The lighting is soft, highlighting the textures of the leather and the plastic components.

MORE SPACE, MORE COMFORT,

Isuzu F-Series trucks are equipped with a spacious cab, to minimize fatigue and create a pleasant and productive working environment for any driver, on any road. With best in class dimension, there is ample room to spread out, with a day cab that has lots of clever storage compartments that help reduce clutter in the cabin.

A spacious sleeper cab with a wider sleeper bed also provides adequate resting place for the crew during long hauls.



EFFORTLESS OPERABILITY

Power steering / adjustable column power steering and tilt / telescopic column adjustment are standard, helping to reduce driver fatigue. Simple operation meters are located in the center for superior visibility, surrounding switches are designed for easy control.



High-visibility meters, simple operation

Meters are in the center for superior visibility, allowing drivers to confirm vehicle status at a glance. Surrounding switches are designed for easy control.



Covered overhead shelf

Ideal for communications equipment or long items



Room mirror

Allows driver to check rear of cabin and through rear window



MORE ACCESS

Three steps and hand grips facilitate cab ingress/egress



Smooth and effortless shifting

Refinements to the master cylinder reduce the effort involved in manual shifting and ensure a smooth ride. Reliability and durability are also enhanced.



Cup holders

Holds two cups or cans within easy reach of driver



Door Ashtray



Header Console



AM/FM radio

Produce superior sound quality

MORE VISIBILITY



Better mirror visibility for safer driving

Wide-angle mirrors on the driver's side and co-driver's side as well as front and side under mirrors on the co-driver's side expand visibility, helping to prevent "under run" and contact accidents during turns or merging.

MORE GREEN



Optimal power from Small displacement.

Isuzu engineers pushed the limits of engine technology to develop the common rail diesel engines which delivers unmatched fuel economy and reduced carbon emissions. Technologically advanced engine management features are perfectly complemented with rugged construction to reduce total cost-of-ownership and ensure reliability even in harsh operating conditions. The four-cylinder 4HK1-TCC / TCS provide optimal power required for your everyday deliveries. For long-haul transport and more demanding applications, six-cylinder 6HK1-TCN / TCS offer the ultimate output and torque.

- 4HK1-TCC** Direct-injection OHC
- Displacement 5,193cc
 - Max. Output 140kW (190PS) / 2,600rpm (net)
 - Max. Torque 510N•m (52kg•m) / 1,600rpm (net)

- 4HK1-TCS** Direct-injection OHC
- Displacement 5,193cc
 - Max. Output 154kW (210PS) / 2,600rpm (net)
 - Max. Torque 637N•m (65kg•m) / 1,600rpm (net)
 - 706N•m (72kg•m) / 1,600rpm (net)

- 6HK1-TCN** Direct-injection OHC
- Displacement 7,790cc
 - Max. Output 177kW (240PS) / 2,400rpm (net)
 - Max. Torque 706N•m (72kg•m) / 1,450rpm (net)

- 6HK1-TCS** Direct-injection OHC
- Displacement 7,790cc
 - Max. Output 206kW (280PS) / 2,400rpm (net)
 - Max. Torque 882N•m (90kg•m) / 1,450rpm (net)



Turbocharger

The turbocharger realizes high output from small displacement. The result is improved fuel economy and reduced emissions.

Common-rail fuel injection system

Electronic control injects fuel at extremely high pressure in 1/1000 second units and determines optimal injection amounts, reducing NOx and particulate matter.

Electronic control technologies

Proprietary ISUZU electronic control technologies are the key to precise regulation of combustion in order to deliver peak power, environmental performance and fuel economy. Every F-Series model takes full advantage of cutting-edge ISUZU electronic control.



Designed for easy maintenance

When there is a big job, Isuzu F series will be ready. The quick access front panel facilitates routine replenishment of clutch and washer fluids as well as brake valve maintenance.



Cleaning the windshield is a snap

A full-length bumper step and hand grips take the hard work out of cleaning the windshield. The bumper step and grips also offer steady support for adjustment of mirrors. For remote adjustment from inside the cab, power mirrors are available.

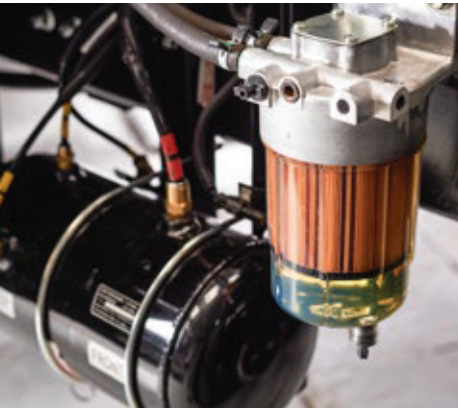

Simplified fluid inspection and other service work

Checking fluids is simple. An engine oil inspection port is located at the back of the cab, along with brake fluid and long-life coolant reservoirs. The relay box is also conveniently placed at the back of the cab for straightforward inspection. Even fuse replacement inside the cab below the instrument panel is easy, thanks to a cartridge-type fuse box.

MODEL	GVW	DRIVE SYSTEM	ENGINE
FRR90	11,000	4*2	4HK1-TCC
FTR	12,200/13,000	4*4	6HK1-TCN
FTS	15,000	4*2	4HK1-TCS
FVR	18,000	4*2	6HK1-TCN
FVZ	26,000	6*4	6HK1-TCS



F-SERIES TECHNICAL SPECIFICATIONS

FTS

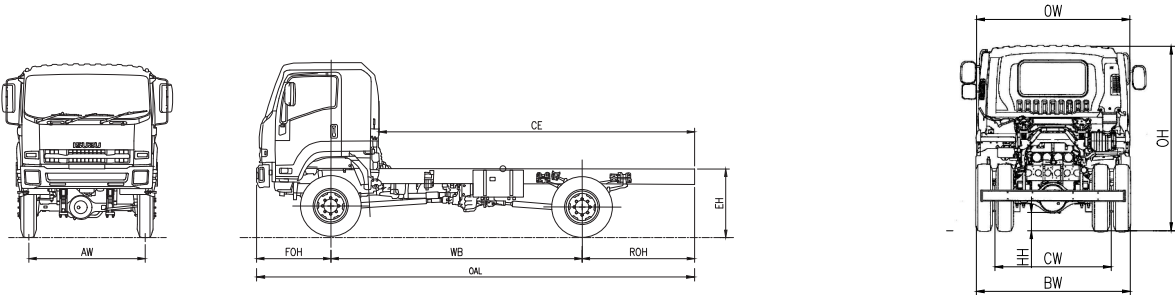

FRR
FVR

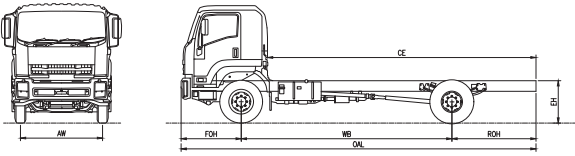

FVZ
FVX

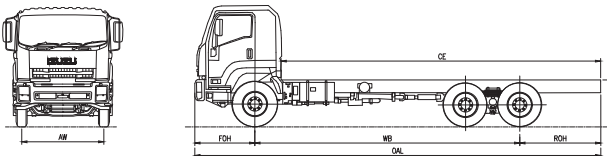

MODEL	FRR90N	FVR90L	FVR90P	FTS34K	FTS34L	FVR34P	FVZ34T, Cargo Truck Chassis	FVZ34N, Tipper Chassis	FVZ34N, Mixer Chassis
ENGINE									
Model	4HK1-TCC	4HK1-TCS	4HK1-TCS	6HK1-TCN	6HK1-TCN	6HK1-TCN	6HK1-TCS	6HK1-TCS	6HK1-TCS
Type	Diesel 4 Cylinder, Common Rail Turbocharged with Intercooler			Diesel 6 cylinder , Common Rail Turbocharged with Intercooler					
Displacement (L)	5193	5193	5193	7790	7790	7790	7790	7790	7790
Max Output kW (hp) @ rpm	140(190) @ 2,600	154(210) @ 2,600	154(210) @ 2,600	177 (240)@ 2,400	177 (240)@ 2,400	177 (240)@ 2,400	206(280) @ 2,400	206(280) @ 2,400	206(280) @ 2,400
Max Torque Kgm (Nm) @ rpm	52(510) @ 1,600	72(706) @ 1,600	72(706) @ 1,600	(72)706 @ 1,450	(72)706 @ 1,450	(72)706 @ 1,450	90(882)@ 1,450	90(882)@ 1,450	90(882)@ 1,450
Pre-Air Cleaner & High-Air Intake Pipe	Standard								
Fuel Water Sedimentors	Standard								
Heavy Duty Radiator	Standard								
Emission	Euro IV								
CLUTCH									
Type	Type: Dry Single Plate Operation: Hydraulic Control, Air Assist								
Diameter (mm/inch)	355/14"	355/14"	355/14"	381/15"	381/15"	381/15"	381/15"	381/15"	381/15"
TRANSMISSION									
	6 Speed	6 Speed	6 Speed	6 Speed	6 Speed	9 Speed	9 Speed	9 Speed	9 Speed
SUSPENSION	Front: Multi Leaf Spring Shock Absorbers - Double Acting Rear: Multi Leaf Spring with Helper Spring								
BRAKES									
System	Air Over Hydraulic Dual Circuit					Full Air Dual Circuit, with Air Dryer and Auto Brake Lining Adjustment			
Air Dryer	Equipped	Equipped		Equipped		Equipped	Equipped	Equipped	Equipped
Park Brake	Center Drum Parking	Center Drum Parking	Center Drum Parking	Center Drum Parking	Center Drum Parking	Wheel Parking	Wheel Parking	Wheel Parking	Wheel Parking
Front& Rear	Drum	Drum	Drum	Drum	Drum	Drum	Drum	Drum	Drum
Auxiliary	Exhaust Brake	Exhaust Brake	Exhaust Brake	Exhaust Brake	Exhaust Brake	Exhaust Brake	Exhaust Brake	Exhaust Brake	Exhaust Brake
Speed limiter	80km/h	80km/h	80km/h	80km/h	80km/h	80km/h	80km/h	80km/h	80km/h
STEERING									
Operation	Power Assited								
CAB									
Type	Tilt Cabin Construction								
Sleeper Cab	Standard								
Seat Belt	3 Point x 2 For Driver & Assistant, 2 Point x 1 For Center Seat								
USB Port	Equipped	Equipped	Equipped	Equipped	Equipped	Equipped	Equipped	Equipped	Equipped
AM - FM Radio	Standard	Standard	Standard	Standard	Standard	Standard	Standard	Standard	Standard
Cab Tilt Switch & Warning Light	Equipped	Equipped	Equipped	Equipped	Equipped	Equipped	Equipped	Equipped	Equipped
Manual Levelling Headlamp Switch	Equipped	Equipped	Equipped	Equipped	Equipped	Equipped	Equipped	Equipped	Equipped
WHEELS & TYRES									
Tyre Size	10R/17.5 Tubeless	11R/22.5 Tubeless	11R/22.5 Tubeless	13R22.5	10.00R22.5	12.00R22.5 Tubeless	12.00R22.5 Tubeless	12.00R22.5 Tubeless	12.00R22.5 Tubeless
Rim Size	17.5 x 6.00	8.25 x 22.5	8.25 x 22.5	9.00 x 22.5	7.5 x 22.5	8.25 x 22.5	8.25 x 22.5	8.25 x 22.5	8.25 x 22.5
FRONT AXLE									
Gross Allowable Weight (Kg) Fr	3600	6300	6300	4700	4700	7500	7500	7500	7500
REAR AXLE									
Gross Allowable Weight (Kg) Rr	7700	10500	10500	7500	9200	13000	25000	25000	25000
FUEL TANK									
Capacity (Litres)	200	200	200	200	200	200	370	370	370
Final Drive Ratio (:1)	6.833	6.833	6.833	6.5	5.571	6.143	6.143	7.167	7.167
WEIGHT (kg)									
Gross Vehicle Weights: GVW (Kgs)	11000	15000	15000	12200	13000	18000	26000	26000	26000
Front Axle Weight (Kg)	2025	2860	2815	3030	3005	2915	3320	3045	3045
Rear Axle Weight (Kg)	1235	1740	1900	1950	2065	2195	3985	3965	3965
Cab Chassis Mass (Kgs)	3260	4600	4715	4980	5070	5110	7305	7010	7010
GRADEABILITY									
Gradeability %	30	40	40	39	39	39	33	39	39
FLEET MANAGEMENT SYSTEM (FMS)									
FMS System	Equipped	Equipped	Equipped	Equipped	Equipped	Equipped	Equipped	Equipped	Equipped

DIMENSIONS (mm)	Overall Length	Overall Width	Overall Height	Wheelbase	Front Overhang	Rear Overhang	Rear Axle Width	Front Track	Rear Track	Chassis Rear Height at Axle	Front Chassis Width	Rear Chassis Width	Rear Ground Clearance	Cab to Chassis End	Cab to Axle
FRR90N	8155	2200	2600	4860	1170	2125	2160	1790	1660	950	840	840	195	6595	3965
FVR90L	7405	2400	2880	4250	1440	1715	2445	1970	1845	1095	870	870	245	5335	3620
FVR90P	8505	2400	2720	5050	1440	2015	2445	2445	1845	1095	870	870	245	6435	4420
FTS34K	6742	2400	2983	4100	1362	1280	2287	1965	1968	1220	850	850	275	4569	3289
FTS34L	7405	2400	2935	4250	1255	1900	2350	1965	1790	1120	850	850	275	5335	3435
FVR34P	8505	2400	2880	5050	1440	2015	2445	1970	1845	1250	870	870	245	6435	4420
FVZ34T, Cargo Truck Chassis	9730	2400	2870	6350	1440	1940	2445	1970	1845	1220	870	870	265	7660	5070
FVZ34N, Tipper Chassis	7630	2400	2905	4250	1440	1340	2445	1970	1845	1220	870	870	265	5650	3660
FVZ34N, Mixer Chassis	7630	2400	2905	4250	1440	1340	2445	1970	1845	1220	870	870	265	5650	3660

A Truck for Every Application
There is a wide variety of rear bodies, application-specific models and modifications to choose from, depending on the specialised needs of your business.



Power Tailgate Flatbed Recovery Truck Tipper



Aerial Lift Wrecker Tanker



Garbage Compactor Crane / Cargo Refrigerated Van



Earth Auger Exhauster Road Sweeper

Customized / specialized solutions and designs available.



Trucks for life
ISUZU

CONTACTS

Enterprise Road, Industrial Area

Tel: 0800 724 724

Info.kenya@isuzu.co.ke

www.isuzu.co.ke

